



REDEFINE THE WAY OF LIFE



USER MANUAL

MODEL	RCH-ASPIRA-90SS
SERIAL NO.	

COOKER HOOD

READ & SAVE THIS INSTRUCTIONS MANUAL

CONTENTS

SPECIFICATIONS -----	3
PRODUCT DIMENSION -----	3
OPERATING INSTRUCTIONS -----	4
INSTALLATION REQUIREMENT -----	6
INSTALLATION PROCEDURES -----	7
MAINTENANCE (installation of charcoal filter) -----	8
IMPORTANT SAFETY INSTRUCTIONS -----	11
TROUBLE SHOOTINGS -----	13
WARRANTY CARD -----	14

Dear Valued Customer,

Congratulations and thanks for trusting RUBINE as part of your kitchen appliances. This product is subject to strict Quality Control during the entire process of manufacturing and assembly. It is meticulously tested to ensure lowest defect possible when it is used in your kitchen. Do not remove the product from its protective packaging until it is installed.

Please read and understand the instruction carefully before proceeding to install and use the appliances. The information contained in this manual is essential for proper operation of the appliance and, more importantly, for your safety. Being socially and environmentally responsible, the packaging of the appliance has been manufactured using only materials which are strictly necessary to guarantee efficient protection during transport.

To contribute to the environment, you can dispose the packaging into appropriate recycling bin. You can contact your local authority to find out the nearest recycling centre for your old product. Do not pour used oil down the sink; instead, collect in sealed container and take it to an appropriate oil disposal centre to avoid ground water contamination.

IMPORTANT: The quality of the final product is recorded according to the serial number. In the unlikely event that the appliance should be damaged or not meeting your expectations in terms of quality, please inform us as soon as possible. For the warranty to be valid, the appliance must not been tampered with, or used inappropriately.

SPECIFICATIONS

Model Name : RCH-ASPIRA-90SS

Total Power : 224W

Motor Power : 220W

LED Lamp : 1x4W

Voltage : 220V – 240V

Frequency : 50Hz

PRODUCT DIMENSION

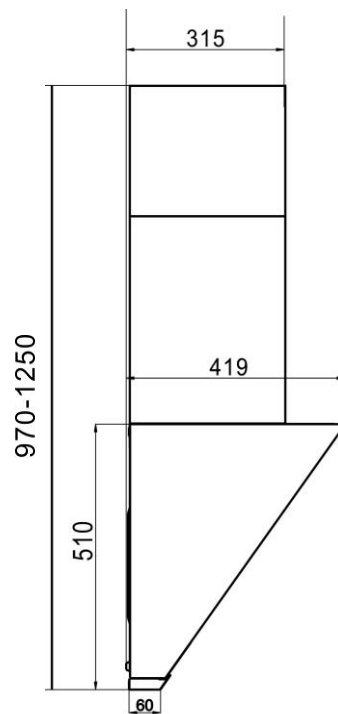
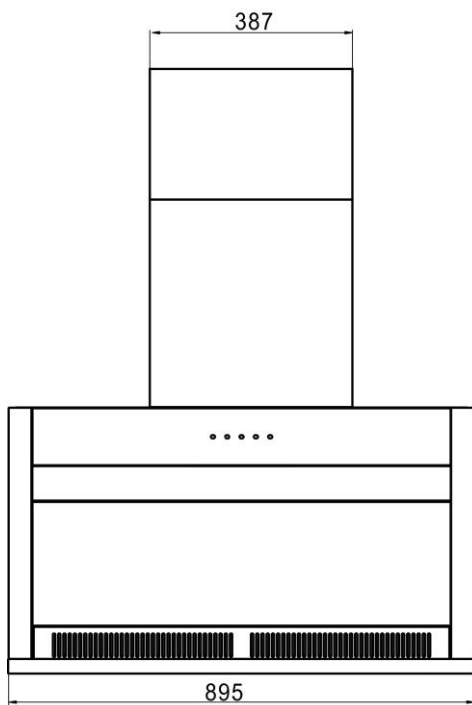

OPERATING INSTRUCTION

This is a highly sensitive touch control. Gently press the control to operate.

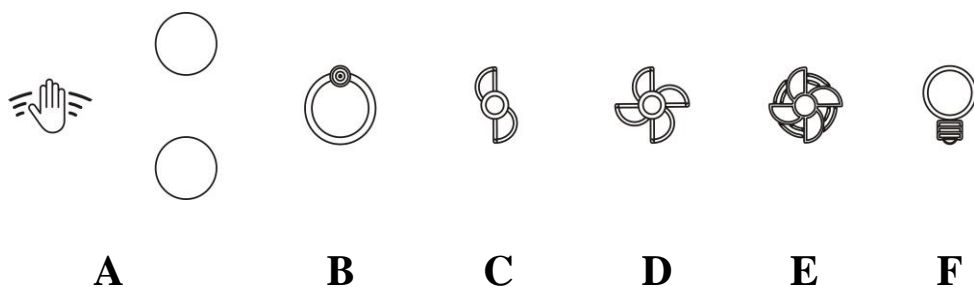

A	B	C	D	E	F
Hand Sensor Zone	Power / Delay	Low Speed	High Speed	Boost	Light

Power/Delay button:

Press the “Power/Delay” button to turn on the range hood, the “Power/ Delay” button flashes, and the range hood will power up. Press the “Power/Delay” button to turn off the range hood, the “Power/ Delay” button flashes, and the range hood will enter delay state for 1 minute and will power off the range hood after the delay is over. This is to clear the air after cooking completion.

In the delay state, press the “Power / Delay” button again to turn immediately turn off the range hood.

Low Speed button:

In the power-on state, press the “Low Speed” button once, and the range hood will run in low gear.

Fast Speed button:

In the power-on state, press the “Fast Speed” button once and the range hood will run in fast speed.

Boost button:

In the power-on state, press the “Boost” button once, and the hood will run in the boosted mode. After running for 3 minutes, it will automatically change to the fast speed. This is to provide better suction during deep frying.

Light button:

Press the light button to turn on the light, and press the light button again to turn off the light.

Hand Sensor zone:

When the range hood is in off state, wave your hand slowly in front of the hand sensor zone, the range hood will power up in fast speed, wave your hand again to turn off the range hood.

INSTALLATION REQUIREMENT

1. To have the optimum suction performance, do not install cooker hood near to door and windows. External wind will reduce the efficiency of the range hood. (Fig. 1)
2. Install range hood directly above the hob. The optimum distance between the cooker hood and hob is 300mm to 350mm. (Fig. 2)
3. For best suction performance, minimize the length of the ducting hose, minimize the number of angles and do not over-bend the pipe more than 90 degree. (Fig. 3)
4. Ensure the cooker hood is vertically straight after installation. (Fig. 4)
5. The air outlet **MUST NOT** be connected to chimney flues or combustion gas ducts. **DO NOT** connect the air outlet to ventilation duct which fuel-burning appliances are installed

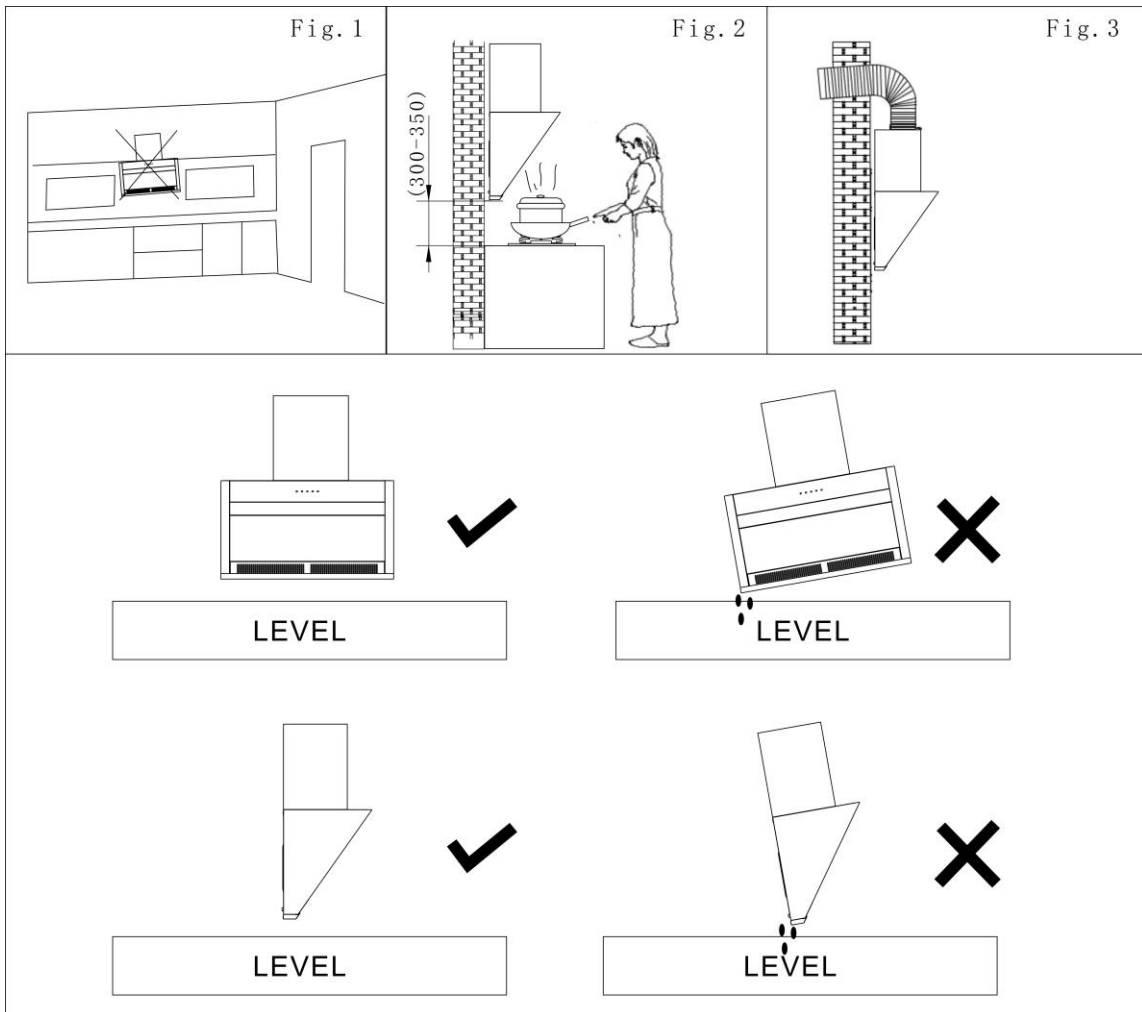

INSTALLATION PROCEDURES

SAFETY WARNING

Some parts of the range hood may have very sharp edges. Please wear protective gloves if you need to remove any parts during installation, cleaning or servicing. Make sure the wall is able to hold / withstand the weight of cooker hood. It should not have contact with any cable inside / outside to avoid electric shock. Do refer your hob user manual for any special requirement.

Step 1:

Install the cooker hood according to the recommended distance between 300mm to 350mm above the hob.

Step 2:

Drill holes on the proper positions of the wall, insert the provided wall plug into the holes. Tighten the screw into the holes and ensure it is tightly screwed. Hang the cooker hood on the bracket and ensure it is level and stable.

Step 3:

Fix the ducting hose into the air outlet of the inner duct. It has to be tightly connected.

Step 4:

- a.) Adjust the desired height of the inner duct and draw 2 markings against the bracket holes.
- b.) Put the inner duct aside and drill the holes, then insert the wall plug into the holes.
- c.) Place the inner duct on the wall and tightened it with screw and ensure bracket is aligned.

Step 6:

Extend the air outlet ducting hose outdoor.

MAINTENANCE

To ensure efficiency & product lifespan, clean the range hood surface & motor regularly. Before any cleaning & maintenance, make sure the range hood is switched-off and unplugged. Wear glove during maintenance to avoid injuries or scratching the range hood.

Use mild soap or detergent solution to clean the surface once a week depending on the usage

Motor fans and other internal part should be cleaned once every 6 months, depending on usage. This should be conducted by Qualified personnel only. Do not clean the motor with water or others liquid.

Oil Filter & Motor Turbine Dismantling Method

Please make sure the components are place gently after dismantle to avoid any dented to the component.

- 1.Remove out the oil filter (A). Then remove the three screws from the lower panel (B). Then Push up and take out the glass panel (C).
- 2.Remove the four screws on the upper panel and remove the baffle filter (A).
- 3.Unscrew and remove the motor turbine rime cover (A).
- 4.Unscrew the motor turbine nut (A). Then, take out the motor turbine (B).

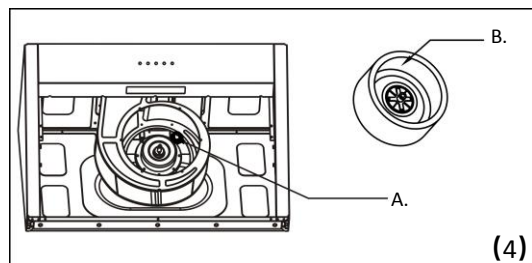
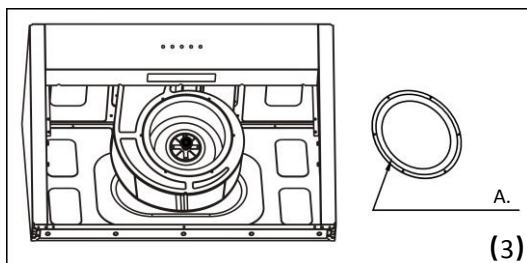
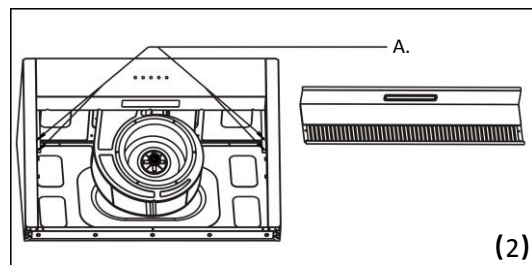
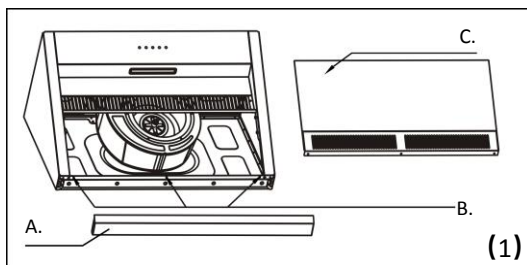

For Charcoal Filter Installation

1. Remove out the oil filter (A). Then remove the three screws from the lower panel (B). Then Push up and take out the glass panel (C).
2. Remove the four screws on the upper panel and remove the baffle filter (A). Then, install the charcoal filter to the location show by Arrow (B).

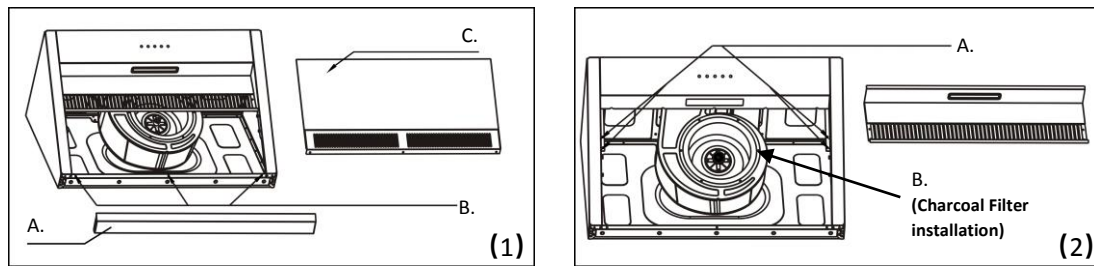

Installation of Extended Ducting Hose Cover

1. Install the range hood, use a measuring tape to measure the distance from the ceiling of the kitchen to the top of the range hood ducting hose cover to determine the height of the extended decorative cover.
2. Use a measuring tape to measure the distance from the top of the ducting hose extension cover to the hole of the ducting hose extension cover, and use this distance to determine the position of the ducting hose extension cover from the ceiling of the kitchen.
3. Fix the ducting hose extension cover on the wall with screws, then pull out the extended ducting hose cover part and fix it on the fixing bar on the left and right sides. (Pictured)

Installation of Ducting Hose Cover

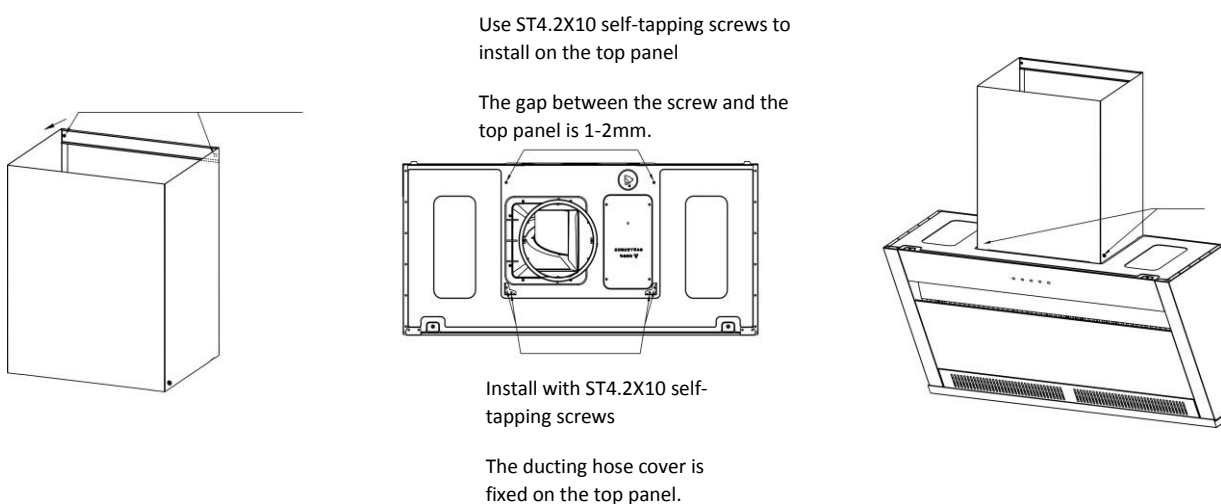

Cleaning of the component

Use mild soap or detergent solution to clean the component. Do not use organic solvents. Soak it for 30 minutes before wash. Ensure to avoid any damages to the component. After clean it with mild soap or detergent solution, wash it again with water & wipe it with dry cloth. Only use dry cloth to clean electrical components, do not use water or any soap on it.

Dismantle & Replacement of LED Light

Caution: Hot surface! To dismantle and replace the LED light, ensure that the range hood is switched-off and unplugged.

- Use a flat head screwdriver to pull out the LED light subassembly
- Pull out from the connection with internal wires.
- Replace with new LED light
- Connect the LED light subassembly with internal wires and push the lamp into the hood.

IMPORTANT SAFETY INSTRUCTIONS:



Do not connect the air outlet to chimney flues or combustion gas ducts.

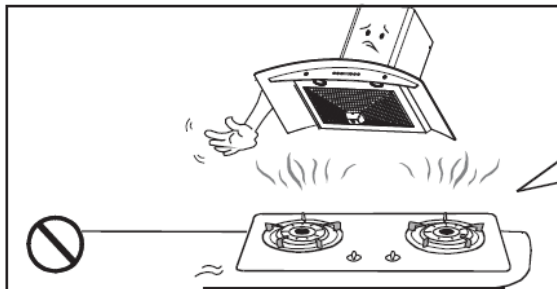

Do not leave bare flames under this hood.

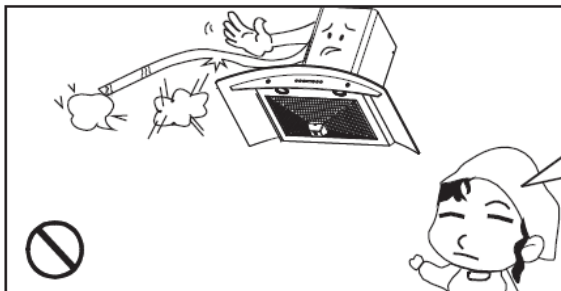

In case of any damage to power cable, replace the broken cable with a new one by qualified personnel.

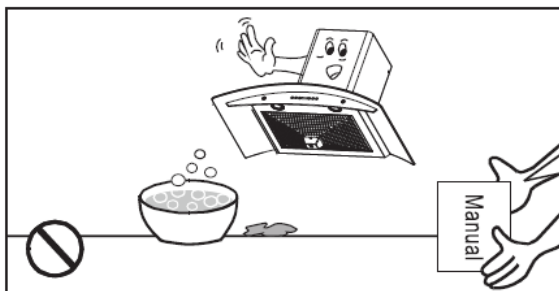

Clean the appliance by following the instruction given in the manual.

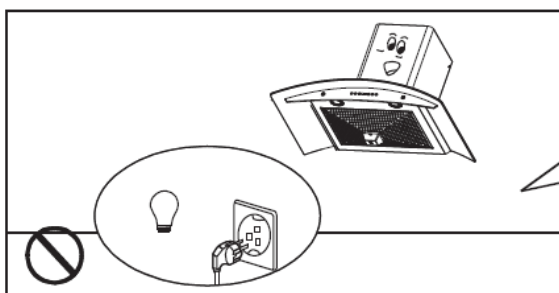

Replacement of the bulb should be undertaken by a qualified electrician or a competent person.

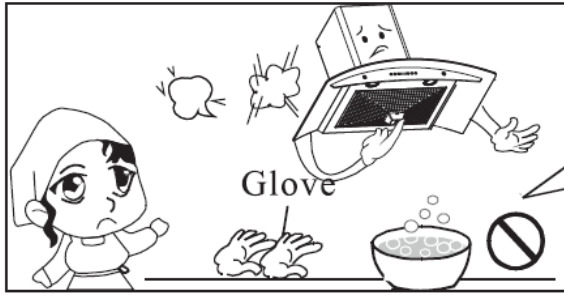

Put on protective glove before you start to clean the hood. Remove the components gently when cleaning.



Never wash the control switch with water or any kind of liquid. Liquid might cause electrical problem to the hood.

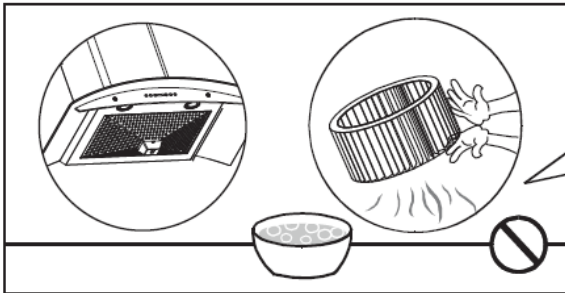

Cleaning of the motor fan should be undertaken by a qualified personnel be careful to avoid any distortion of the fan during cleaning.

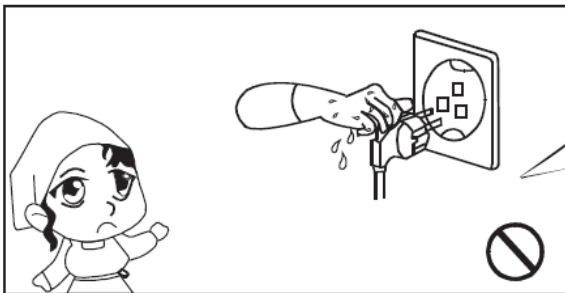

Never pull the plug out of the power supply with wet hand to avoid the possibility of electric shock.

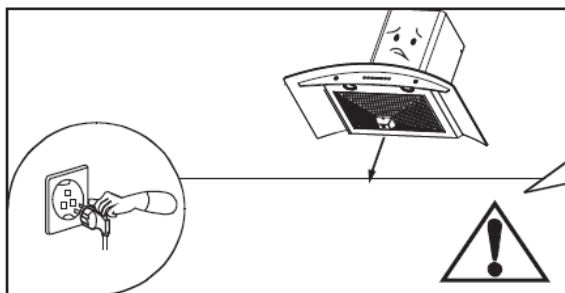

Disconnect the cooker hood from the power supply if this appliance will not be used for a long period of time.

TROUBLESHOOTINGS

Malfunctions	Causes	Action
LED light malfunction while motor is operating	LED light is not install	Contact service centre & request technician to: - install the LED light - replace new LED light
	LED light is not install correctly	
	LED light broken	
Both motor & LED light are malfunction	Plug & socket might be damaged or might not be connected correctly	Repair / change new plug or socket
	Display board might be damaged or might not connect correctly	
LED light is on but motor is not operating	Thermal protector damaged	Change motor
	Capacitor damaged	Change capacitor
	Motor damaged	Change motor
Hood is shaking	Blower not installed correctly	Adjust the blower
Noisier	Ducting cover not installed correctly	Check & tighten ducting cover
Weak Suction	Hood installed too far from hob	Adjust the distance
	Air / wind convection	slightly open door/ window
	Hose installed too long, connection point did not seal correctly, too many bending or deform	Check & install the hose correctly
	Butterfly vane is close	Remove the tape, adjust hose to ensure no blockage
	Hob install too far from cooker hood	Adjust hob position
	Low power supply to hood	Check the flow of power supply 200-240 V

Customer Care

Exact Quality Sdn. Bhd.
Contact : 03 – 6286 9000
Website : <http://www.e-quality.com.my/>

OPERATION HOURS
08:30am - 06:00pm
(Monday - Friday, except public holiday)



FOR HOOD MOTOR ONLY



FOR ALL PARTS
(EXCLUDING ACCESSORIES)



**1-year
Warranty
Extensions
When Register
Online!**

Online Registration

1. Log on to www.rubine.com.my
2. Click on 'Support', followed by 'Products Warranty Registration' to proceed. You are required to sign up as a member.
3. Please fill up the necessary information, tick on the Checkbox and click 'Next'.
4. You'll receive a notification of warranty registration confirmation via email.
5. Your warranty will be automatically extended for another 12 months upon registration online. Please keep your online warranty certificate for reference.

rubine.com.my



FIAMMA TRADING SDN BHD 330476-P (A member of Fiamma Holdings Berhad)
9-2, Wisma Fiamma, No.20, Jalan 7A/62A, Bandar Manjalara, 52200 Kuala Lumpur. Tel: 03-6279 8943