



LEAD THE CHANGE



USER MANUAL

MODEL

RCH-NOVARA-90SS

SERIAL NO.

COOKER HOOD

USER INSTRUCTIONS

GENERAL

ATTENTION

Read this manual carefully to ensure proper and safe usage of your appliance. It is advisable to retain the instruction manual and installation instructions for future use or for subsequent owners. Your safety is guaranteed if the appliance is correctly installed according to the safety instructions. The installer is to ensure that the appliance works perfectly well at its installation location. This appliance is intended for domestic use and household environment only. The appliance is not intended for outside use. Always ensure that the appliance is not left unattended during operation. The manufacturer is not liable for damage which is caused by improper usage or incorrect operation. This appliance has been designed to be used up at a maximum height of 2,000 metres above sea level. Usage by children who are over the age of 8 years old and persons with reduced physical, sensory or mental capacity or persons with a lack of experience or knowledge must be supervised by someone who is responsible for their safety, or have been instructed in how to use the appliance safely and have understood the risks involved in not using it properly. Children must not play with the appliance. Children under 15 years of age should not engage themselves with the appliance maintenance and cleaning of the appliance unless they are being supervised. Children below the age of 8 years should be kept at a safe distance from the appliance and power cable.

Do not connect the appliances should there be any damage found after unpacking. Please contact the seller immediately. This appliance is not intended for operation with an external clock timer or a remote control.

CONTENTS

PAGE NUMBER

Accessories & Packing List	1
Parts Name Diagram	1
Electrical Circuit Diagram	1
Main Technical Parameter	2
Warning.....	2
Installation Diagram.....	3
Installation Steps.....	5
Safety Instructions.....	6
Operating Instructions.....	6
Cleaning and Maintenance.....	6
Troubleshooting.....	8

Accessories & Packing List

1. Range Hood x 1 unit
2. User Instructions manual x 1 pc
3. Flow Exit x 1 pc
4. Flow Exit seal x 1 pc
5. Oil clection container x 1 pc
6. Flexible exhaust duct x 1 pc

Parts Name Diagram

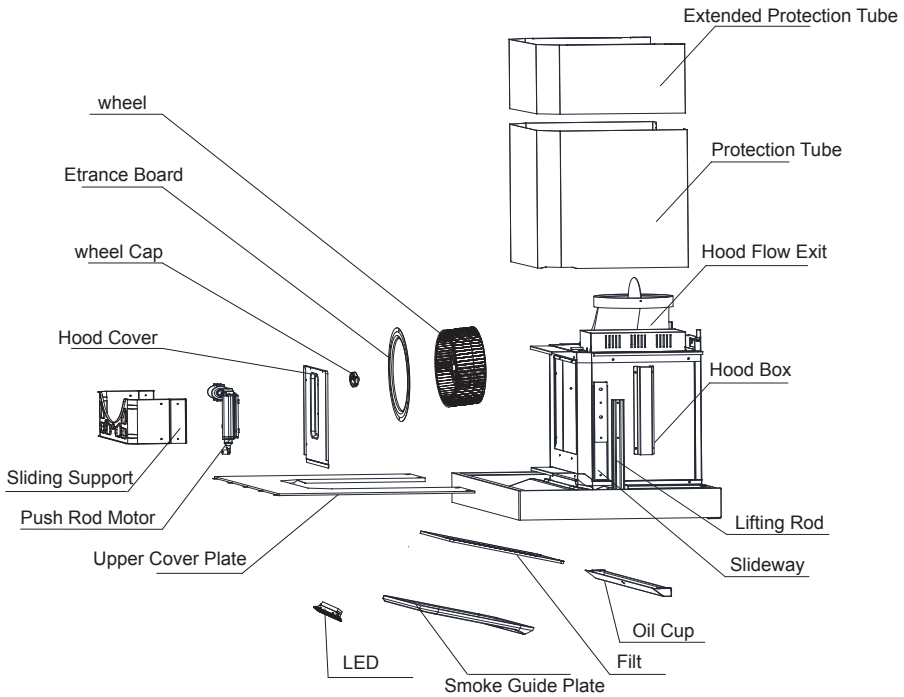

Electrical Circuit Diagram

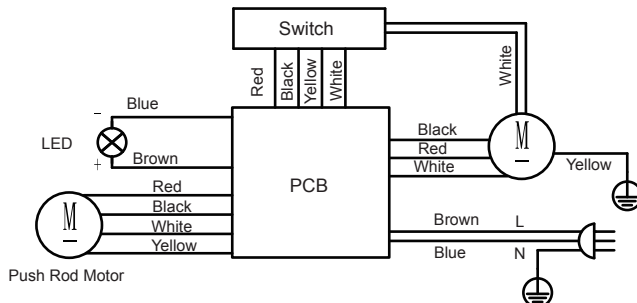

Main Technical Parameter

Model No.	RCH-NOVARA-90SS
Rated Voltage	220-240V~
Rated Frequency	50-60Hz
Product Size	895X520X655(mm)
Max Noise Level	67dB
Max Pressure	820Pa
Standard Pressure	600Pa
Lighting	≤4W
Motor Power	230W
Total Power	234W
G.W	34kg
N.W	29kg

Warning

Warning: Danger of suffocation!

Packaging materials especially plastic bag is harmful to childre. Do not allow children to play with packaging materials.

Warning: Danger of death!

Risk of gas poisoning from withdrawn gas; always ensure that the room is highly ventilated if the appliance is being operated in exhaust air mode at the same time as room air-dependent heat-producing appliance is being operated like gas, oil, wood or coal-operated heaters, continuous flow heaters or water heaters and many more secures high level of combustion air from the room in which they are situated and discharge the exhaust gases into the open air through an exhaust gas system (e.g. a chimney). In combination with an activated vapour extractor hood, room air is extracted from the kitchen and neighbouring rooms - a partial vacuum is produced if not enough fresh air is supplied. Toxic gases from the chimney or the extraction shaft are sucked back into the living space. Ventilated air must therefore always be ensured. An incoming/exhaust air wall box alone will not ensure compliance with the limit. Safe operation is possible only when the partial vacuum in the place where the heat-producing appliance is installed does not exceed 4 Pa (0.04 mbar). This can be achieved when the air needed for combustion is able to penetrate through openings that cannot be sealed, for example in doors, windows, incoming/exhaust air wall boxes or by other technical means.Unrestricted operation is possible if the vapour extractor hood is operated exclusively in the circulating-air mode.

Warning: Risk of fire!

Gas burners when operated on may generate intense heat without the absence of a cookware placed on them which as a result a ventilation appliance installed above the cooker may become damaged or catch fire. Therefore only operate the gas burners with cookware on them. Does not operating several gas burners at the same time, this gives rise to a great deal of heat. A ventilation appliance installed above the cooker may become damaged or catch fire. Never operate two gas burners simultaneously on the highest flame for longer than 15 minutes. One large burner of more than 5 kW (wok) is equivalent to the power of two gas burners.

Warning: Risk of burns!

The exposed parts of the appliances experiences a great rise of heat when in operation, do not touch the exposed parts as they could be really hot, more also keep children at a safe distance.

Warning: Risk of injury!

Components inside the appliance may have sharp edges. It is necessary to put on protective gloves when handling these appliances. Items placed on the appliance may fall down. Do not place any objects on the appliance. The light emitted by LED lights is very dazzling, and can damage the eyes. Do not look directly into the switched on LED lights for longer than 100 seconds.

Warning: Risk of injury!

Risk of trapping body parts when opening and closing the ducting; do not reach into the area behind the ducting cover panel, and keep your fingers away from the hinges.

Warning: Risk of electric shock!

If the appliance is defective, unplug the appliance from the mains or switch off the circuit breaker in the fuse box. Contact the after-sales service. Wrong fixations can be harmful. Repairs may only be carried out by an authorized technician. Do not use any high-pressure cleaners or steam cleaners, which can result in an electric shock.

Installation Diagram

IMPORTANT: Installation must be carried out by our registered contractors.

1) Installation Height

Minimum height from the hob surface to the underside of range hood:

- 350 mm for electric hob
- 400 mm for gas hob

*If the instruction for the gas hob installation specified a greater distance, this has to be taken into account

NOTE: Any installation above 700mm will compromise the performance of this range hood.

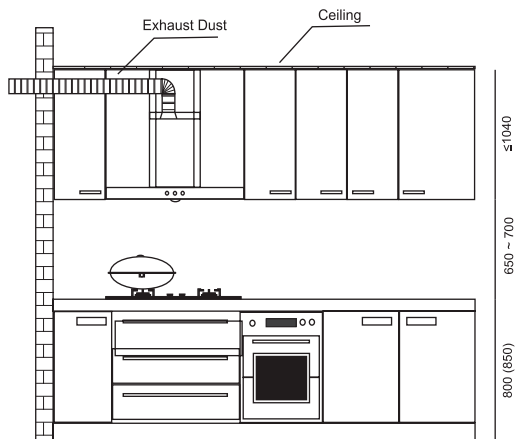

If the ceiling is low and hood is installed without extended chimney, there should be at least 3cm gap between the ceiling and chimney.

2) Exhaust Duct

The length of the exhaust duct should be minimised to avoid air turbulence inside the duct.

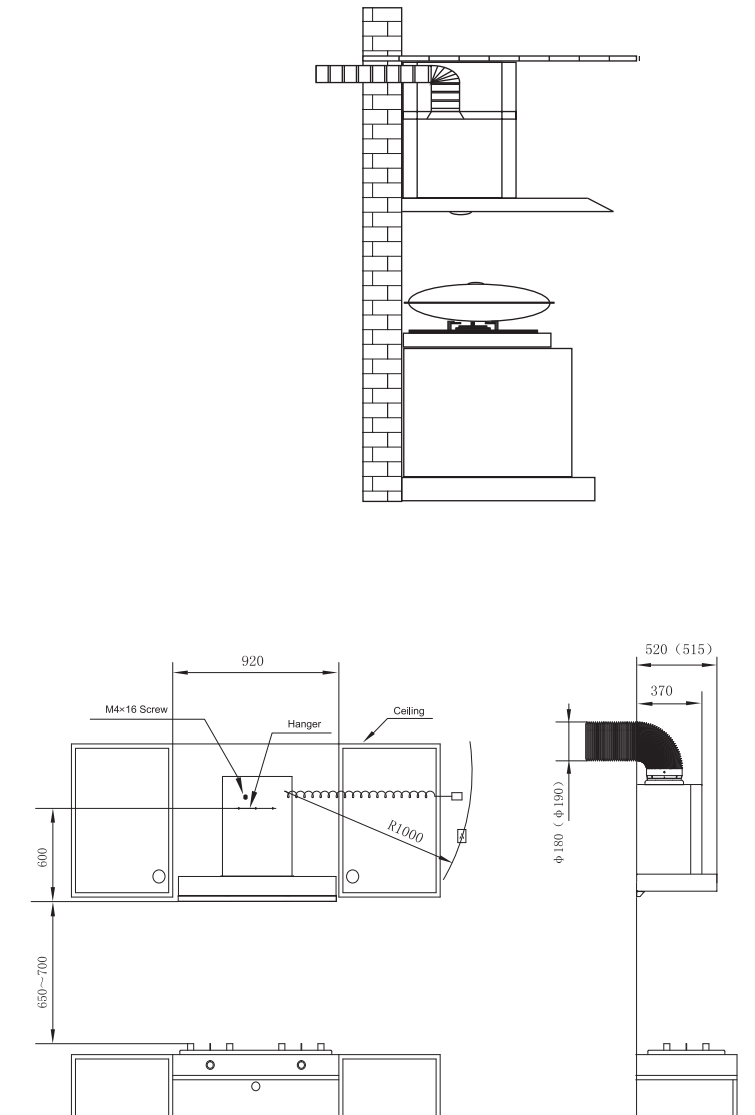

Installation Steps

Top View

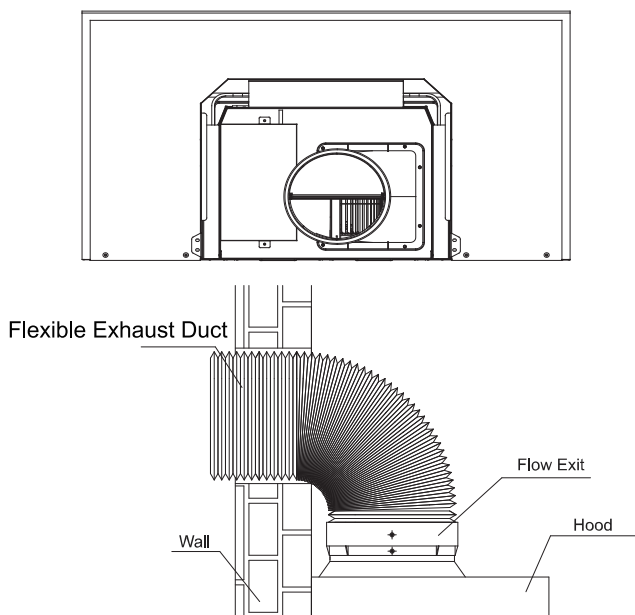

1. Determine height between cooker hob and base of hood.
2. Mark wall to suit all bracket locations. Drill holes of 50mm depth at the selected drilling position.
3. Insert the expansion tubes to fix the bracket onto the wall.
4. Install the flow exit to the hood and follow by connecting the flexible exhaust duct to the flow exit.
5. Strengthened the connection between the flow exit and the flexible exhaust duct with screws.
6. Lift and hang the hood to the wall bracket and please ensure it sits firmly on the bracket.
7. Direct the other end of the flexible exhaust duct to the outlet or wall.
8. Fit in the safety baffle of the hood onto the wall to strengthen the position and to reduce vibration when the hood is switched on.
9. Chimney extension can be installed to the ceiling or wall.
10. Ensure the oil collection container is in place before the hood is being used. To remove it for cleaning, slide the oil collection container from front to rear, vice versa for inserting it into position.

Safety Instructions

1. Ensure there is proper ventilation in the cooking area.
2. Instructions concerning the discharge of air have to be followed.
3. Do not flambe under the range hood.
4. Avoid using materials which could cause spurts of flame near the range hood.
5. Never touch the lamp when it is on.
6. Do not dismantle, repair or modify the range hood on your own.

Operating Instructions

Confirm that when the hood is installed, plug in the power plug, and the hood sends out a "drip" sound, indicating that the power is connected.

Please use the following methods for the first time. If there is any discrepancy, please contact the local distributor or service department as soon as possible.



There are five buttons on the front panel as shown above: Illumination, Boost, Wake-Up (also touch this button to adjust the airflow), Lock-Screen, Delay/Stop.

For the first time to start the hood, please press the Wake-Up button first and then touch the ring clockwise and the airflow will get bigger and bigger. When the whole ring is red, it starts to suck at the the highest power and also the Boost button will be lighted.

Illumination Button: If you want to turn on the light, just press the Illumination Button once; and if you want to turn it off, press the button one more time.

Boost Button: When you touch this button, the cooker hood will work at a "boost" mode. When the whole ring (Wake-Up button) is lighted, this button will also be lighted.

Wake-Up Button: You can touch this button to wake up the hood and also touch it clockwise to adjust airflow. At the same time, smoke deflector will descend to a certain height according to the airflow.

Lock-Screen Button: In the on-state, touch and hold the Button for 3 seconds to enter the mode of Lock-Screen. In this mode, other buttons will be locked so you can remove the smoke deflector and filter to clean.

Delay/Stop Button: This hood has the function of delayed shutdown. When you press this Button once, the fan will continue to stay in working state for 3 minutes. After 3 minutes, it will automatically stop. If you want to turn it off immediately, please press the Button twice.

Clock-Setting: Touch and hold the Delay/Stop Button for 3 seconds to enter the clock-setting state, and the clock hour bit will start to flash. Press Boost Button or Lock-Screen Button to adjust hour display. Then press Delay/Stop Button again and minute digit will flash, its adjustment is the same. Finally, press Delay/Stop Button again to save the clock setting.

Cleaning and Maintenance

Cleaning filter

1. Press lock screen key for 3 seconds and suction plate will descend to the lowest position. Unlock the suction plate by pulling the front panel down and remove the plate by taking off the hook at the back of the panel. Turn off the mains to prevent electric injury. Caution; oil might spill from the base of the plate.
2. Remove the oil cup by pulling it towards your direction.
3. The screws can be removed easily by fingers.
4. The screws can be removed easily by fingers.
5. The screws can be removed easily by fingers.

Cleaning blower fan

Due to the complication built of this model, it is highly recommended to contact our service team for cleaning.

1. Remove the ducting cover after the screws are removed at the back.
2. Remove the screw at the bottom of the push rod motor.
3. Remove the screws from the hood cover.
4. Remove the screws from the entrance board.
5. Remove the wheel cap.
6. Remove the blower fan.

Warning: Risk of burns!

The appliance becomes hot during operation. Always tap to test the temperature and allow the appliance to cool down before cleaning.

Warning : Risk of electric shock!

Penetrating moisture may result in an electric shock. Clean the appliance using a damp cloth only. Before cleaning, pull out the mains plug or switch off the circuit breaker in the fuse box.

Warning: Risk of electric shock!

Do not use any high-pressure cleaners or steam cleaners, which can result in an electric shock.

Warning: Risk of injury!

Components inside the appliance may have sharp edges. Wear protective gloves.

Warning: Risk of injury!

Risk of trapping body parts when opening and closing the metal front; do not reach into the ducting cover, and keep your fingers away from the hinges. Protect your skin from long duration contact with harsh or abrasive cleaning agents, e.g. scouring powder or liquid scouring cleaner, cleaning products with a high alcohol content, hard scouring pads or cleaning sponges, pressure washers or steam cleaners, cleaning products that dissolve lime scale, aggressive all-purpose cleaning products and oven spray.

Note: Wash new sponge cloths thoroughly before use.

Note: All instructions and warnings should be strongly adhering to.

Cleaning guide

Stainless steel	Hot soapy water: Clean with a dish cloth and then dry with a soft cloth.
	Clean stainless steel surfaces in the direction of the grain only.
	Special stainless steel cleaning products are available from our after-sales service or from specialist retailers. Apply a very thin layer of the cleaning product with a soft cloth.
Painted surfaces	Hot soapy water: Clean using a damp dish cloth and then dry with a soft cloth.
	Do not use stainless steel cleaner.
Aluminium and plastic	Hot soapy water: Clean with a soft cloth.
Glass	Glass cleaner: Clean with a soft cloth. Do not use a glass scraper.
Controls	Hot soapy water: Clean using a damp dish cloth and then dry with a soft cloth.
	Risk of electric shock caused by penetrating moisture.
	Risk of damage to the electronics caused by penetrating moisture. Never clean controls with a wet cloth.
	Do not use stainless steel cleaner.

Troubleshooting

PROBLEM	POSSIBLE CAUSES	SOLUTION
Motor and light do not operate	Power plug is not inserted completely	Check the plug and insert it properly
	The light bulbs are blown	Change the bulbs
	The wire and / or cable is disconnected	Contact us for product servicing
	The light's transformer is damaged	Contact us for product servicing
Motor cannot operate but the lights are working	The impeller is stopped	Contact us for product servicing
	The capacitor is disconnected and / or damaged	Contact us for product servicing
	The motor is damaged	Contact us for product servicing
The range hood vibrates or shakes while in operation	The range hood is not installed levelly or the wall which it is installed upon is not solid	Install the range hood to a solid and steady wall
	The motor is not properly installed	Fasten the motor tightly to the body
	The damaged impeller is affecting the levelness of the range hood	Contact us for product servicing
Only one or two buttons can function while others are not working	The control panel is not functioning properly	Contact us for product servicing
	Connection with the control board is loose	Reconnect loose wires to the control board
Weak / Low Suction Power	The range hood is installed too high from the cooking hob	Lower the installation of the range hood
	There are blockages in the exhaust duct.	Remove the dirt / blockages inside the duct
	Air convection is too strong around the appliance	Do not open too many windows during cooking to improve the quality of the suction power
Oil Leakage	The range hood is not installed levelly	Install the range hood levelly

WARRANTY CARD

WARRANTY CONDITIONS

Subject to following Term & Conditions, this equipment is guaranteed against defective material & manufacturing defects by Fiamma Trading Sdn Bhd for a period of twelve (12) months from the date of original purchase. Fiamma Trading Sdn Bhd reserves the right to change these terms & conditions without prior notice.

Terms & Conditions:-

- 1) This warranty is valid & provided that warranty card is completed with authorized dealer's stamp from the date of original purchase and in the territory of Malaysia only.
- 2) This warranty covers repair or, at the option of Fiamma Trading Sdn Bhd, replacement of any parts proven to be defective due to defective workmanship or material provided that the product was purchased from an authorized dealer of Fiamma Trading Sdn Bhd.
- 3) This warranty does not cover the damage resulting from:
 - (a) Any unauthorized disassembly, service repair, alteration or modification being carried out.
 - (b) Abnormal voltage or the use of generator and/or used not in accordance with the Operating Manual / User Manual.
 - (c) Misuse, abuse, negligence or accident howsoever caused.
 - (d) Normal wear or tear.
 - (e) Rough handling & transportation.
 - (f) Commercial / public use e.g. hotel, laundry, college, university, etc.
- 4) This warranty does not cover the following accessories:
 - (a) Burner Caps/Supports (b) Cast Iron Grib (c) Knobs (d) Body Work (e) Light Bulb (f) Charcoal / Filter (g) Cover (h) Glass Cover / Screen (i) Trays/Shelves (j) Hose
- 5) This warranty is considered null & void in the events if:
 - (a) Any item contained in this warranty card has been tempered with or altered in any way without the prior written consent of Fiamma Trading Sdn Bhd. Request for warranty services within the warranty period must be accompanied with this warranty card & proof of original purchase.
 - (b) Any time during the warranty period, any part / parts of this equipment is / are removed, altered, tempered with, adjusted, modified, dismantled, repaired or handled in any way whatsoever by any person / persons not authorized by us.
 - (c) The serial number of the product has been defaced or removed.
- 6) Warranty for WINE CHILLER compressor is (5) five years, gas refill and labor charges are excluded.
- 7) In the event of defects covered by this warranty arising during the warranty period, the purchaser shall be fully responsible for the due delivery to our dedicated service centre of the equipment (expect for the refrigerator, washing machine, ovens, cooker hood, gas cooker, dishwasher, dryer, built-in hob, freezer, water heater) for any work which shall need to be done pursuant to this warranty & subsequent collection thereof of the equipment after the said work has been done.
- 8) This warranty is in lieu of any, and all other warranties expressed or implied warranty of merchantability or fitness for a particular purpose. Fiamma Trading Sdn Bhd assumes no liability for the breach of the warranty beyond correcting the breath in the manner described above. In no event shall Fiamma Trading Sdn Bhd be liable for consequential losses or damages, including loss of use or loss of profits resulting from the product.

FOR OFFICE USE

Model Name

Serial No
Barcode :

Customer's Name (In Block/Full Name)

Date of Purchase : DAY MTH YR

Customer's Address (Full Address) :

PostCode : State :

Customer's Tel No : (H) - (O) -

Customer's Email : (H/P) -

Authorised dealer's stamp
Fiamma Trading Sdn. Bhd.

Customer Signature

Customer **Care**

AFTER-SALES SERVICE:

Exact Quality Sdn. Bhd.

Hotline: **1800-282-093**

Email: **eqservice@fiamma.com.my**

OPERATION HOURS

08:30am - 06:00pm

(Monday - Friday, except public holiday)

Our **Warranty**

5*yrs*
Warranty

FOR HOOD MOTOR ONLY

1*yr*
Warranty

FOR ALL PRODUCTS

(EXCLUDING ACCESSORIES)

6*mths*
Warranty
Extension

**6-months
Warranty
Extensions
When Register
Online!**

Online Registration

1. Log on to www.rubine.com.my
2. Click on 'Support', followed by 'Products Warranty Registration' to proceed. You're required to sign up as a member.
3. Please fill up the necessary information, tick on the checkbox and click 'Next'.
4. You'll receive a notification of warranty registration confirmation via email.
5. Your warranty will be automatically extended for another 6 months upon registration online. Please keep your online warranty certificate for reference.

rubine.com.my



FIAMMA TRADING SDN BHD 330476-P (A member of Fiamma Holdings Berhad)

9-2, Wisma Fiamma, No.20, Jalan 7A/62A, Bandar Manjalara, 52200 Kuala Lumpur. Tel: 03-6279 8943