



INSTANT WATER HEATER

REDEFINE THE WAY OF LIFE



REDEFINE THE WAY OF LIFE

Leading the change over the past 20 years

Rubine is the leading household appliances brand for the past 20 years with wide range of technologically advanced products with innovative designs.

INNOVATION

Innovation is the core value of Rubine's ideology and fundamental in development of our unparalleled quality and durable products. All products are designed and built to the highest standards with newest innovations to ensure our products will always perform to the best and reflect the modern trends towards a better living environment.

QUALITY

Top quality, high functionality and irresistible elegance in our product designs, matched by our excellent post sales services are part of our 20 years' tradition. Our aspiration of "Redefine The Way Of Life" will promise to deliver unprecedented and satisfactory user experience.

EFFICIENCY

We employ groundbreaking technologies to develop energy-efficient household appliances to conserve the environment and to improve quality of life, for today and tomorrow.



Instant Water Heater With Rain Shower

Optimize your shower experience with our exceptional instant water heater and beautifully designed rain shower.

Product featured: RWH-IA991D-RCB



Instant Water Heater With Chromed Hand Shower

Our high quality water heater can always enhance your lifestyle and provide you with the best shower sensation.

Product featured: RWH-F191D-RMG

REDEFINE SHOWER EXPERIENCES

SHOWER LIFESTYLE CONCEPT

Our innovative technology with versatile functions on Rubine instant water heater and rain shower series will ensure your sensation, comfort, satisfaction and safety while redefining your shower experiences and lifestyle.



OUR WATER HEATER PUMP TYPES

Rubine's instant water heater comes in three types of pump : AC Pump, DC Pump and Non Pump. Pump type choices may varies depending on your living environment and preferred level of water pressure.



SILENT INVERTER DC PUMP

Eco-friendly DC Inverter Technology
Less Power Energy Consumption
Silent Operation with **<45dB**
Maintenance-free
(No carbon change needed)



LOW NOISE INVERTER AC PUMP

Inverter AC Booster Pump
Decreases Carbon Loss
Lower Operation Noise with **<60dB**
(Compare to normal AC)



NON PUMP

Easy and User-friendly
Quality and Affordable

INSTALLATION RECOMMENDATIONS INSTANT WATER HEATER PUMP / NON PUMP MODEL

Installation recommendations and methods to choose water heater pump or non pump model for optimum shower experiences:

 WATER TANK  AC/DC PUMP WATER HEATER  NON PUMP WATER HEATER

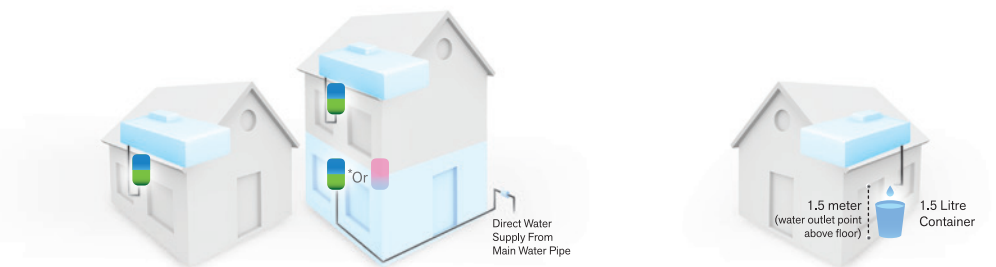

SINGLE STOREY, DOUBLE STOREY AND LOW RISE BUILDING

Water heaters with AC or DC pump are recommended.
*Non pump water heater only if direct water supply from main pipe with strong water pressure.

MEASURE TIME TAKEN TO FILL UP WATER IN A 1.5 LITRE CONTAINER

Water heater with pump	> 16 seconds
Non pump water heater	< 16 seconds

*Results may varies subject to size and distance of pipe from water tank that may affect the water pressure.

OUR RECOGNITIONS



COMFORT

Prioritize your comfort showering experiences with our sophisticated design and exceptional functions.



LOW NOISE INVERTER AC PUMP

Inverter AC Technology gives you extra benefits of stronger water flow with lower operation noise as compared to conventional AC pump.



LOW NOISE OPERATION

With low noise operation of <60db, you can now enjoy powerful and relaxed showering experiences.



STRONG WATER FLOW

AC Booster Pump creates strong water flow up to +/- 5 litre per minute.



LOW BRUSH LOSSES

The AC booster pump with new innovative technology will stabilize current, minimize sparking and decrease carbon loss. With this technology, AC booster pump will have a longer lifespan compared to normal AC pump.



SILENT INVERTER DC PUMP

The Inverter DC technology reduces energy usage and power consumption while maintaining silent operation for the best shower pleasure. DC pump offers a longer lifespan, so you can get more use out of it, thus more saving in the long run.



ECO-FRIENDLY

Longer life span with low power consumption, you can have a greener lifestyle with an enjoyable shower.



SILENT OPERATION

The silent operation of DC Pump creates a peaceful experience which is remarkably quiet at just <45db.



ENERGY SAVING

Save up to **60%** power and energy consumption compared to regular AC Pump.



MAINTENANCE FREE

DC pump uses magnet and brushless technology which makes it longer lasting and no carbon-change maintenance needed.

COMFORT



SLEEK STYLISH ELEGANT DESIGN

Rubine Instant Water Heater comes with variety of sleek and sophisticated design with splash proof protection (IP25 Standard) to secure and enhance a lavish lifestyle.

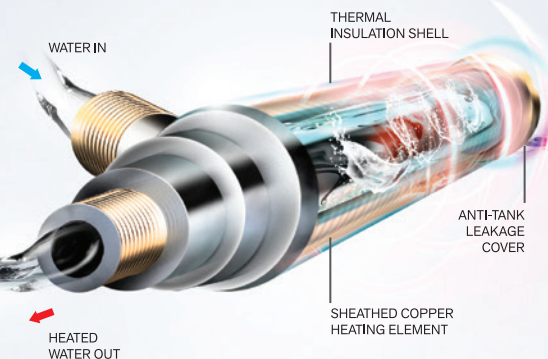

UL-APPROVED HIGH QUALITY UK TECHNOLOGY HEATING ELEMENT

Ensuring peace of mind with quality and reliable UL-approved heating element.



10 YEARS OF WARRANTY
Applicable on
Anti-Tank Leakage only.



7 YEARS OF WARRANTY
Applicable on
Heating Element only.

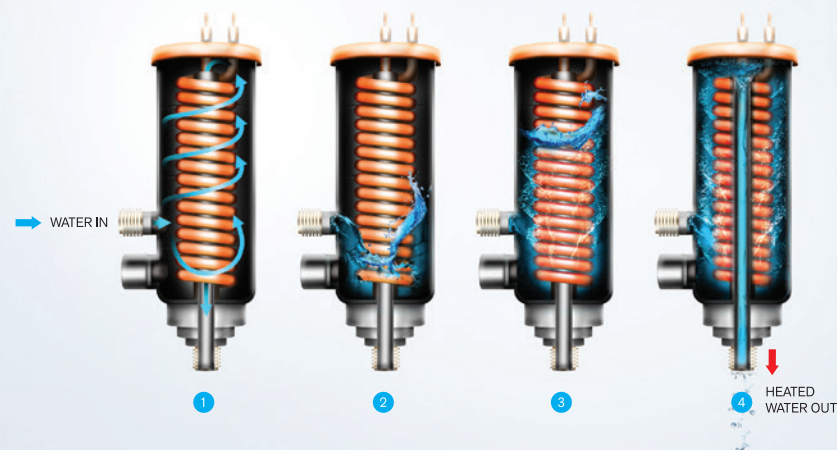

WATER HEATING PROCESS OF UL-APPROVED HIGH QUALITY UK TECHNOLOGY HEATING ELEMENT

INNOVATION

Adopting advanced innovations and transferring the technology into water heaters that is both efficient and ergonomic for all.



29" EXTENDABLE HEIGHT

200mm

180° FULL SWING

ADJUSTABLE ANGLE

SOOTHING SENSATION

180° FULL SWING

360° ANTI-BREAK ROTATION

ANTI-TWIST FLEXIBLE HOSE

PLEASURE SHOWER IN FULL SWING

Shower bar is extendable up to additional of 29 inches and can be steadily swing for 180°, designed to fit any preferred position.

ENJOYABLE SOOTHING SENSATION

The slim rain shower head with diameter of 200mm, comes in design that can be angled to your desired spot. A optimum 63-nozzles shower head, produces the best showering experiences.

EFFECTIVE ANTI-TWIST FLEXIBLE HOSE

The anti-twist hose prevents any loops or knots regardless how many times the shower head is twisted around.



3-IN-1 DIVERTER

All new 3-in-1 function diverter that allows you to switch between rain shower, hand shower and faucet pipe with just a twist of the knob.

HAND SHOWER VARIATION

Rotate between power mist, wide spray, massage, full and combination spray pattern on hand shower for different usage.



MULTIPLE USAGE FAUCET

Additional heated water outlet in your bathroom for various usage apart from showering.



EASY ACCESS OF WARM AND NORMAL TEMPERATURE WATER OULET



WARM WATER FOR HAND WASH CLOTHES



WARM SHOWER FOR BABY BATHTUB



WARM SHOWER FOR PET MADE EASY WITH FAUCET INSTEAD OF HANDHELD HAND SHOWER HEAD



SAFETY

Comply with safety assurances to protect you and your family. Giving a safe and relaxing shower sensation.



INNOVATIVE AUTO INSPECT ALARM

The extra safety built-in Auto Inspection Alarm, serves as a double protection that will checks and detects malfunction on every use. The alarm will set off, if there is malfunction in ELCB or undetectable earth wire.

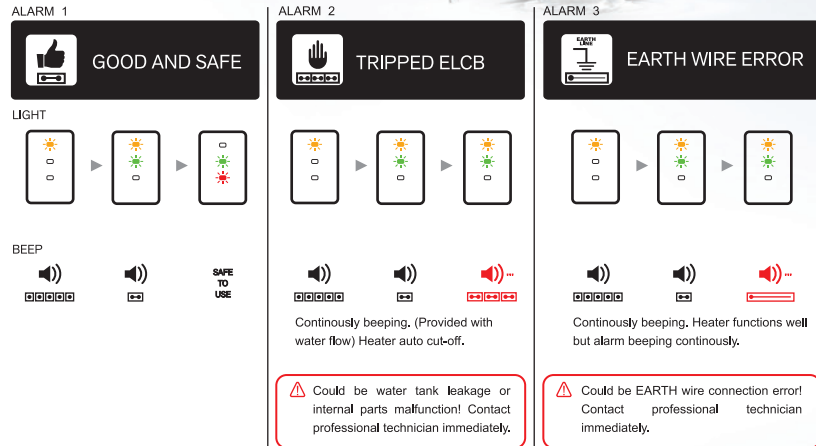

EARTH WIRE INDICATOR

This safety indicator will ensure the earth wire connectivity & reliably earthed.

* Earth wire is to ground the excess current, should any leakage occur.



SPLASH PROOF CASE COVER WITH IEC INSULATED PROTECTION

Comply with IEC approved Splash Proof Protection (IP25 Standard) water-proof cover to avoid any water seepage into the heater.

* Always ensure proper seal installation for your safety.



ELCB cut-off power within **0.1sec** when detects electrical leakage of as low as **15mA**

55°C Anti-scalding auto cut-off (Auto reset)
80°C Abnormal overheating cut-off (Manual reset)

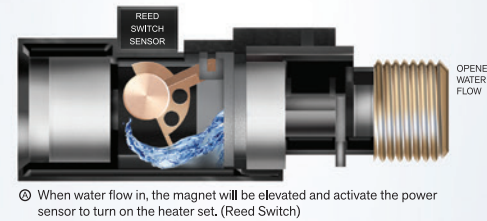

Ⓐ When water flow in, the magnet will be elevated and activate the power sensor to turn on the heater set. (Reed Switch)

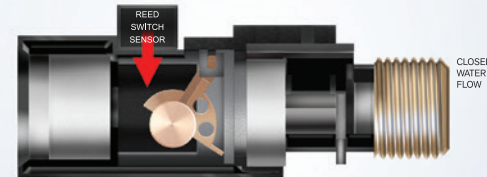

Ⓑ When no water flow in, the magnet will remain and the heater set will not be activated. (Reed Switch)



COMPACT WATER FILTER & STOP VALVE

Equipped with a superior quality stop valve with built-in water filter to ensure better flow efficiency and filters out water particles.



EXTRA SAFETY DPDT PROTECTION SYSTEM

Double Thermal safety cut-off, ensure automatic halt to the temperature if it exceeds a certain point.

- 55°C Anti-scalding auto cut-off (Auto reset)
- 80°C Abnormal overheating cut-off (Manual reset is required)



BUILT-IN AUTO WATER FLOW SWITCH

Automatically detects sufficient water pressure to operate to prevent dryburn.

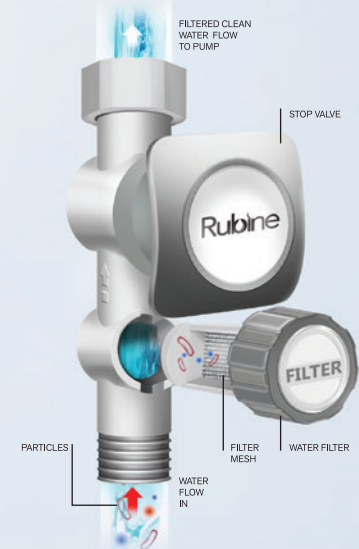



SALVO SERIES



60% ENERGY SAVING
APPLICABLE ON ECO-FRIENDLY SILENT INVERTER DC PUMP

EARTH WIRE INDICATOR

FLOW INDICATOR

RESIDUAL-CURRENT CIRCUIT BREAKER (RCCB) DEVICE

3-IN-1 DIVERTER

SPLASH PROOF CASE COVER WITH IEC INSULATED PROTECTION

BUILT-IN AUTO WATER FLOW SWITCH

EXTRA SAFETY DPDT PROTECTION SYSTEM

COMPACT WATER FILTER & STOP VALVE

UL-APPROVED HIGH QUALITY HEATING ELEMENT TECHNOLOGY FROM UK



SILENT INVERTER DC PUMP

Power Rating	3.8kW 240V 50Hz
Min. Water Pressure	0.2 Bar
Min. Water Flow Rate	1.6ℓ / min
Inlet/Outlet Water Connector	ø15mm (1/2" BSP)
Temperature Control	Stepless Electronic
Pump Type	Inverter DC Silent Pump
Noise Level	<45db
Product Dimension (WxDxHmm)	235x89x380

With Rain Shower Set

- RWH-S701D-RCB
- RWH-S701D-RCR
- RWH-S701D-RPW
- RWH-S701D-RTG

RCP WM RM 1,044 / EM RM 1,099



With Chrome Accessories

- RWH-S701D-CCB
- RWH-S701D-CTG

RCP WM RM 773 / EM RM 814





NON PUMP



Power Rating	3.8kW 240V 50Hz
Min. Water Pressure	0.2 Bar
Min. Water Flow Rate	1.6ℓ / min
Inlet/Outlet Water Connector	ø15mm (1/2" BSP)
Temperature Control	Stepless Electronic
Product Dimension (WxDxHmm)	235x89x380

With Chrome Accessories

CARBON BLACK	RWH-S700N-CCB
TITANIUM GREY	RWH-S700N-CTG

RCP WM RM 453 / EM RM 477

LED ON

LED OFF

FLOW LED INDICATOR

FLOW

Shower set installation & flow switch in order

- ⚠ ① Inlet & outlet installation in reverse or
- ⚠ ② Flow switch (internal) malfunction

HEATER LED INDICATOR

HEATER

Temperature on

Temperature off

EARTH WIRE INDICATOR

EARTH POWER

Earth wire connected

- ⚠ Earth wire disconnected (LED blinking)



SALVO SERIES

PLEASURABLE
SHOWER WITH
PEACE OF MIND

TITANIUM GREY WITH RAIN SHOWER SET
RWH-S701D-RTG

SALVO SERIES

LED INDICATOR

FLOW LED INDICATOR

FLOW

HEATER LED INDICATOR

HEATER

EARTH WIRE INDICATOR

EARTH POWER



STYLISH
STEPLESS
CONTROL

ONE-PUSH
PUMP
CONTROL

PUMP



RESIDUAL-
CURRENT CIRCUIT
BREAKER (RCCB)
DEVICE

Automatically measures and disconnects the circuit when residual current occurs or current exceeds rated sensitivity.

INVENTIVELY
DESIGNED WITH
INNOVATIVE
FEATURES

CARBON BLACK

WITH RAIN SHOWER SET
RWH-S701D-RCB

INTELLIGENT AGENT (IA) SERIES



INNOVATIVE AUTO INSPECT ALARM



60% ENERGY SAVING
APPLICABLE ON
ECO-FRIENDLY SILENT
INVERTER DC PUMP



3-IN-1 DIVERTER



SPLASH PROOF CASE COVER WITH IEC INSULATED PROTECTION



BUILT-IN AUTO WATER FLOW SWITCH



EXTRA SAFETY DPDT PROTECTION SYSTEM



COMPACT WATER FILTER & STOP VALVE



UL-APPROVED HIGH QUALITY HEATING ELEMENT TECHNOLOGY FROM UK



SILENT INVERTER DC PUMP



Power Rating	3.6kW 240V 50Hz
Min. Water Pressure	0.2 Bar
Min. Water Flow Rate	1.6ℓ / min
Inlet/Outlet Water Connector	ø15mm (1/2" BSP)
Temperature Control	Stepless Electronic
Pump Type	Inverter DC Silent Pump
Noise Level	< 45db
Product Dimension (WxDxHmm)	225x84x375

With Rain Shower Set



RWH-IA991D-RCB



RWH-IA991D-RMG



RWH-IA991D-RMP

RCP WM **RM 1,099** / EM **RM 1,156**

With Chrome Accessories



RWH-IA991D-CCB



RWH-IA991D-CMG

RCP WM **RM 835** / EM **RM 879**



NON PUMP



Power Rating	3.6kW 240V 50Hz
Min. Water Pressure	0.2 Bar
Min. Water Flow Rate	1.6ℓ / min
Inlet/Outlet Water Connector	ø15mm (1/2" BSP)
Temperature Control	Stepless Electronic
Product Dimension (WxDxHmm)	225x84x375

With Chrome Accessories



RWH-IA990N-CMG

RCP WM **RM 488** / EM **RM 513**

SLIM SMART ELEGANT(SSE) SERIES



SLIM SMART
ELEGANT SERIES

ELEGANT WITH
HIGH QUALITY
PERFORMANCE

CARBON BLACK WITH RAIN SHOWER SET
RWH-SSE891D-RCB



60% ENERGY SAVING
APPLICABLE ON
ECO-FRIENDLY SILENT
INVERTER DC PUMP



LOW NOISE
OPERATION
APPLICABLE ON LOW NOISE
INVERTER AC PUMP ONLY



2-IN-1 DIVERTER



SPLASH PROOF CASE
COVER WITH IEC
INSULATED PROTECTION



BUILT-IN AUTO
WATER FLOW
SWITCH



EXTRA SAFETY
DPDT
PROTECTION
SYSTEM



COMPACT
WATER FILTER &
STOP VALVE



UL-APPROVED HIGH
QUALITY HEATING
ELEMENT TECHNOLOGY
FROM UK



SILENT INVERTER DC PUMP



Power Rating	3.6kW 240V 50Hz
Min. Water Pressure	0.2 Bar
Min. Water Flow Rate	1.6ℓ / min
Inlet/Outlet Water Connector	ø15mm (1/2" BSP)
Temperature Control	Stepless Electronic
Pump Type	Inverter DC Silent Pump
Noise Level	<45db
Product Dimension (WxDxHmm)	190x87x440

With Rain Shower Set

CARBON BLACK	RWH-SSE891D-RCB
METALLIC GREY	RWH-SSE891D-RMG
MATTE PEWTER	RWH-SSE891D-RMP

RCP WM RM 1,037 / EM RM 1,091



With Black Accessories

CARBON BLACK	RWH-SSE891D-BCB
--------------	-----------------

RCP WM RM 755 / EM RM 795

With White Accessories

MODERN WHITE	RWH-SSE891D-WMW
--------------	-----------------

RCP WM RM 728 / EM RM 766

SLIM SMART ELEGANT(SSE) SERIES



LOW NOISE INVERTER AC PUMP



Power Rating	3.6kW 240V 50Hz
Min. Water Pressure	0.2 Bar
Min. Water Flow Rate	1.6ℓ / min
Inlet/Outlet Water Connector	ø15mm (1/2" BSP)
Temperature Control	Stepless Electronic
Pump Type	Inverter AC Booster Pump
Noise Level	<60db
Product Dimension (WxDxHmm)	190x87x440

With Rain Shower Set

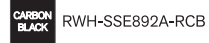

RWH-SSE892A-RCB

RCP WM RM 940 / EM RM 989

With Black Accessories

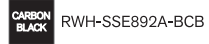

RWH-SSE892A-BCB

RCP WM RM 661 / EM RM 695

With White Accessories

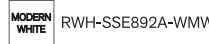

RWH-SSE892A-WMW

RCP WM RM 633 / EM RM 666



NON PUMP



Power Rating	3.6kW 240V 50Hz
Min. Water Pressure	0.2 Bar
Min. Water Flow Rate	1.6ℓ / min
Inlet/Outlet Water Connector	ø15mm (1/2" BSP)
Temperature Control	Stepless Electronic
Product Dimension (WxDxHmm)	225x84x375

With Black Accessories

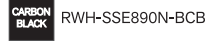

RWH-SSE890N-BCB

RCP WM RM 431 / EM RM 454

With White Accessories

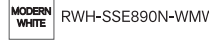

RWH-SSE890N-WMW

RCP WM RM 404 / EM RM 425

FORTE SERIES



FORTE SERIES

ENHANCING
YOUR
MODERN
BATHROOM



WITH RAIN SHOWER SET
RWH-F191D-RMG



60% ENERGY SAVING
APPLICABLE ON
ECO-FRIENDLY SILENT
INVERTER DC PUMP



3-IN-1 DIVERTER



SPLASH PROOF CASE
COVER WITH IEC
INSULATED PROTECTION



BUILT-IN AUTO
WATER FLOW
SWITCH



EXTRA SAFETY
DPDT
PROTECTION
SYSTEM



COMPACT
WATER FILTER &
STOP VALVE



UL-APPROVED HIGH
QUALITY HEATING
ELEMENT TECHNOLOGY
FROM UK



FORTE SERIES

SILENT INVERTER DC PUMP



Power Rating	3.6kW 240V 50Hz
Min. Water Pressure	0.2 Bar
Min. Water Flow Rate	1.25ℓ / min
Inlet/Outlet Water Connector	ø15mm (1/2" BSP)
Temperature Control	Stepless Electronic
Pump Type	Inverter DC Silent Pump
Noise Level	<45db
Product Dimension (WxDxHmm)	190x87x440

With Rain Shower Set

CARBON BLACK	RWH-F191D-RCB
METALLIC GREY	RWH-F191D-RMG
MATTE PEWTER	RWH-F191D-RMP

RCP WM RM 1,064 / EM RM 1,120

With Black Accessories

CARBON BLACK	RWH-F191D-BCB
MODERN WHITE	RWH-F191D-WMW

RCP WM RM 761 / EM RM 801

RCP WM RM 735 / EM RM 773

With White Accessories



NON PUMP



Power Rating	3.6kW 240V 50Hz
Min. Water Pressure	0.2 Bar
Min. Water Flow Rate	1.25ℓ / min
Inlet/Outlet Water Connector	ø15mm (1/2" BSP)
Temperature Control	Stepless Electronic
Product Dimension (WxDxHmm)	190x87x440

With Black Accessories

CARBON BLACK	RWH-F190N-BCB
--------------	---------------

RCP WM RM 439 / EM RM 463

FLUSSO SERIES



FLUSSO SERIES

PREMIERE
COMFORT
SHOWER
EXPERIENCES

CARBON BLACK WITH RAIN SHOWER SET
RWH-FS391D-BRCB



60% ENERGY SAVING
APPLICABLE ON
ECO-FRIENDLY SILENT
INVERTER DC PUMP



2-IN-1 DIVERTER



SPLASH PROOF CASE
COVER WITH IEC
INSULATED PROTECTION



BUILT-IN AUTO
WATER FLOW
SWITCH



EXTRA SAFETY
DPDT
PROTECTION
SYSTEM



COMPACT
WATER FILTER &
STOP VALVE



UL-APPROVED HIGH
QUALITY HEATING
ELEMENT TECHNOLOGY
FROM UK

FLUSSO SERIES



SILENT INVERTER DC PUMP



Power Rating	3.6kW 240V 50Hz
Min. Water Pressure	0.2 Bar
Min. Water Flow Rate	1.25ℓ / min
Inlet/Outlet Water Connector	ø15mm (1/2" BSP)
Temperature Control	Stepless Electronic
Pump Type	Inverter DC Silent Pump
Noise Level	<45db
Product Dimension (WxDxHmm)	227x75x375

With Rain Shower Set

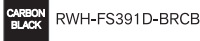

RCP WM RM 938 / EM RM 987



NON PUMP



Power Rating	3.6kW 240V 50Hz
Min. Water Pressure	0.2 Bar
Min. Water Flow Rate	1.25ℓ / min
Inlet/Outlet Water Connector	ø15mm (1/2" BSP)
Temperature Control	Stepless Electronic
Product Dimension (WxDxHmm)	227x75x375

With Rain Shower Set

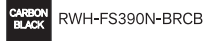

RCP WM RM 656 / EM RM 691



With Black Accessories

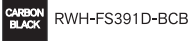

RCP WM RM 713 / EM RM 751

With White Accessories

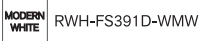

RCP WM RM 687 / EM RM 723



With Black Accessories



RCP WM RM 419 / EM RM 441

With Multi-angle Accessories

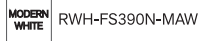

RCP WM RM 371 / EM RM 390



PRODUCT DIMENSIONS

With these actual dimensions, you can choose your preferred design from our wide variety of products and do a better installation plans.

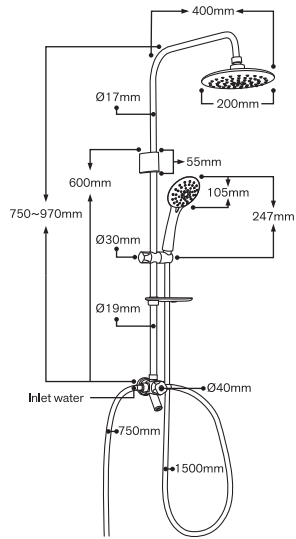

3-IN-1 RAIN SHOWER SET ACCESSORIES

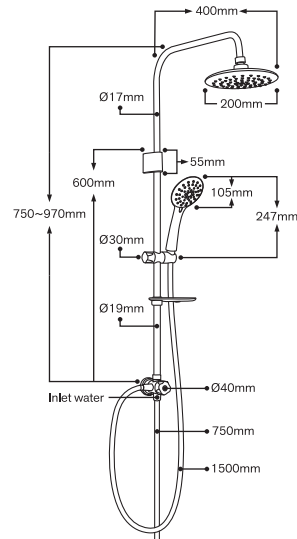

2-IN-1 RAIN SHOWER SET ACCESSORIES

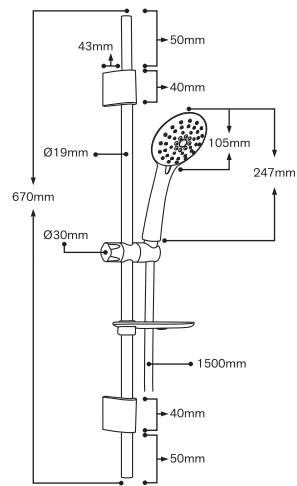

CHROMED ACCESSORIES

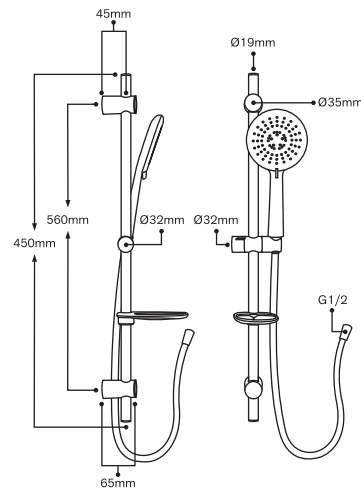

BLACK / WHITE ACCESSORIES

IMPORTANT: ① Dimensional specifications are provided for planning purposes only.
② Do not use modified parts other than original supplied parts.
③ If need shorter/ longer hose, please to contact qualified installers or authorized Rubine servicer dealers for assistance.

INSTANT WATER HEATER MAINTENANCE TIPS

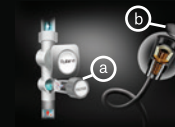

FILTER CLEANING

For smooth flow and purified water, wash the Water Filter Valve (a) and Hose Filter (b) thoroughly every month or when necessary.



CHECK ELCB/RCCB REGULARLY

Turn on the electricity and water supply to the heater. Pressing in the "Test" button. Both the "Power" & "Heater" indicator light must go off. Press the "Reset" button to resume power. Consult professional for repair if there is any malfunction of ELCB/RCCB.



SWITCH OFF WATER HEATER WHEN NOT IN USE

Switch off water heater after every shower. This will minimise any electrical damage and also save electricity bill.



EXTERNAL WATER FILTER FOR YOUR HOUSE WATER SYSTEM

You are encourage to install external water filter to maintain purity and optimum stability of water pressure for your showering experiences.

SAFETY PRECAUTION - DO AND DON'T

Do and don't as a simple guidance to secure you and your beloved family's safety with quality and longer life span of water heater uses.



Flexible 3 Core 2.5mm²
(110/76 20Amp Cable)



2.5mm² PVC Single Core
Insulated Cable with
100% Pure Copper



Children and elderly or disable
person should be supervised



Always ensure the right water
temperature before showering

✓ CORRECT WIRING QUALITY WITHOUT LOOPING

Change wiring with quality specification and do not make looping and share with other appliances while installing water heater.

✓ CHILDREN SHOULD BE SUPERVISED WHILE USE

Ensure that children do not play with the appliances and make sure not to leave children, elderly or disable person alone in shower.



✗ Do not install with
unqualified products



✓ Install with our genuine quality
nonconductive products



✗ Do not leave
hand shower idle in the pail

✗ METAL / CHROMED FLEXIBLE HOSE AND CONDUCTIVE VALVE SHALL NOT BE USED

Assure your safety by using our genuine quality nonconductive flexible hose. Do not replace or install with unqualified products.

✗ DO NOT LEAVE HAND SHOWER IDLE IN THE PAIL

Leaving hand shower in pail will minimize the water flow, causing abnormal overheating and thermostat may cut off.

⚠ IMPORTANT INSTALLATION GUIDELINES

Here are some simple guides of installation and safety precaution.
Always refer to user manual thoroughly and understand the content before use.

1. MOUNTING POSITION

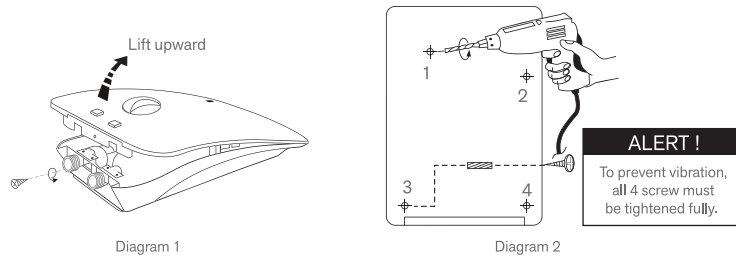

- Remove screw at the bottom of the heater.
- Lift the plastic cover upward (Refer Diagram 1).
- Mark mounting position on the wall for all 4 screws.
- Drill the holes with 5.0mm diameter drill bit (Refer Diagram 2).
- Install the unit to the wall with plug.
- It is recommended that the unit should be mounted above 1.5m or 5-feet above the floor to bottom of heater.

2. INSTALLATION OF HEATER INLET AND OUTLET

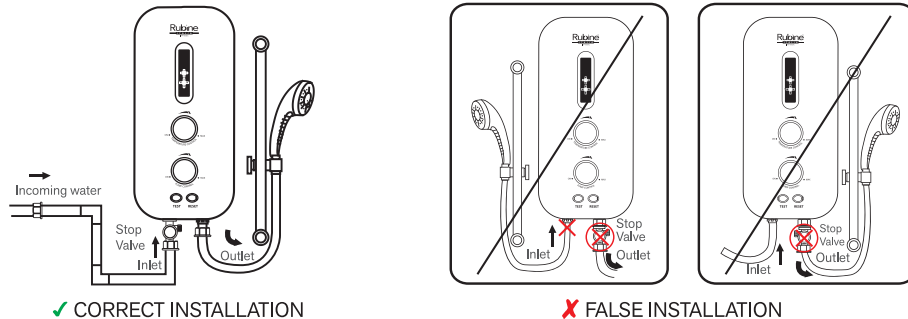

Connect the stop valve to INLET, connect the piping from stop valve to incoming water supply and connect flexible hose to heater OUTLET

Do not install with inlet-outlet reverse or stop valve reverse.

3. ELECTRICAL CONNECTION

- Insert electrical cable through the rubber grommet.
- Connect the cable to the terminal block and fully tighten as below :

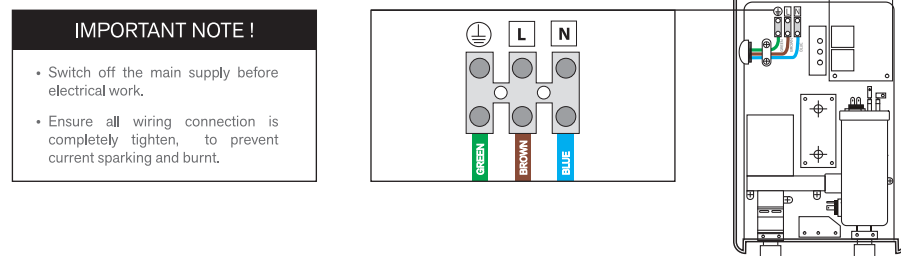

OUR WARRANTY



10 YEARS OF WARRANTY
APPLICABLE ON
ANTI-TANK LEAKAGE ONLY.



7 YEARS OF WARRANTY
APPLICABLE ON
HEATING ELEMENT ONLY.



5 YEARS OF WARRANTY
APPLICABLE ON
SILENT INVERTER DC PUMP ONLY.



1.5 YEARS OF WARRANTY
APPLICABLE ON **LOW NOISE INVERTER AC PUMP ONLY.**



1 YEAR OF WARRANTY
APPLICABLE ON
INTERNAL PARTS ONLY.



6 MONTHS OF WARRANTY EXTENSION
REGISTER ONLINE NOW AND GET
6 MONTHS WARRANTY EXTENSION !

ONLINE REGISTRATION

- Log on to www.rubine.com.my
- Click on 'Support', followed by 'Products Warranty Registration' to proceed. You're required to sign up as a member.
- Please fill up the necessary information, tick on the checkbox and click 'Next'.
- You'll receive notification of warranty registration confirmation via email.
- Your warranty will be automatically extended for another 6 months upon online registration. Please keep your online warranty certificate for future services.

* Please find out from our authorized dealers for extended warranty!



CUSTOMER CARE & WAYS TO REACH TO US



AFTER-SALES SERVICE

Contact: 03 – 6279 8899
Email: ftcrm@fiamma.com.my



OPERATION HOURS

09.00am – 05.00pm
Monday–Friday, except public holiday

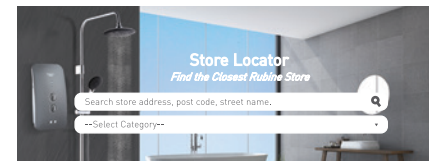

WAYS TO REACH TO US

Whenever you think of instant water heater, please pay a visit to your nearest Rubine store or find us online to get instant inquiry: rubine.com.my

*Product images are for illustration purposes only.





REDEFINE THE WAY OF LIFE

V1.2021

rubine.com.my



FIAMMA TRADING SDN BHD 330476-P (A member of Fiamma Holdings Berhad)
2-1, Wisma Fiamma, No.20, Jalan 7A/62A, Bandar Manjalara, 52200 Kuala Lumpur.

 [rubinemalaysia](https://www.facebook.com/rubinemalaysia)
 03-6279 8899